

# SAM, DRYWALL ANCHOR

## Mounting in drywall

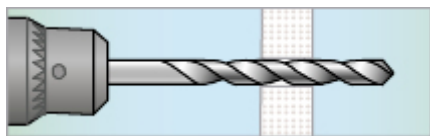

1. Drill the hole according to Technical data below. Be careful not to damage the drywall on the back and around the exit hole.

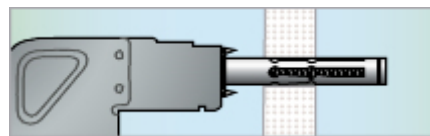

2. Push SAM drywall anchor through the hole.

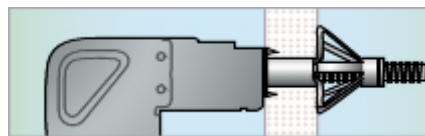

3. Expand using the pliers SAM. When there is resistance and the fixing feels stable the metal expander has reached the correct expansion.  
NOTE! If the screw needs to be screwed in for further expansion, it is important not to over expand the expansion part.

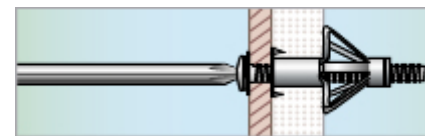

4. Unscrew the screw and secure the detail. The installation is finished.  
NOTE! If an impact wrench is used, it is important not to over-tighten the screw as this can affect the expansion part.

### Technical data

Dimension	Single drywall Tension load (N) / Shear load (V) kg
Sam 4E	14 / 20
Sam 5E	16 / 40
Sam 6E	18 / 45

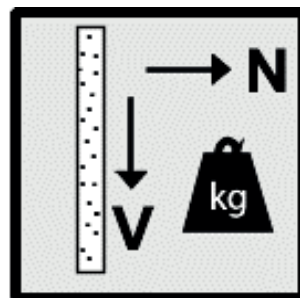

Dimension	Drill diameter mm Ø	Screw	Screw length mm	Max Fixture thickness mm	Drywall mm
Sam 4E	8	M4	45	14	8-16
Sam 5E	11	M5	58	20	8-16
Sam 6E	13	M6	58	20	8-16